

### Notes and Specifications

1. Continuous cavity tray
2. Metal cover flashing
3. Angled timber flashing support fixed to wall with downstand
4. Tegral TFV10 low profile over-fascia vent fixed to upstand
5. 18mm min. wide continuous upstand fixed to timber grounds which are fixed to wall at 600mm centres to provide a 10mm gap with wall
6. Metal Apron flashing fixed to upstand
7. Suitable metal flashing clips at centres to suit exposure
8. Tegral Thrutone slates
9. Slating battens
10. Underlay carried up upstand
11. Truss/Rafter
12. Extra wide top/double batten
13. Wall

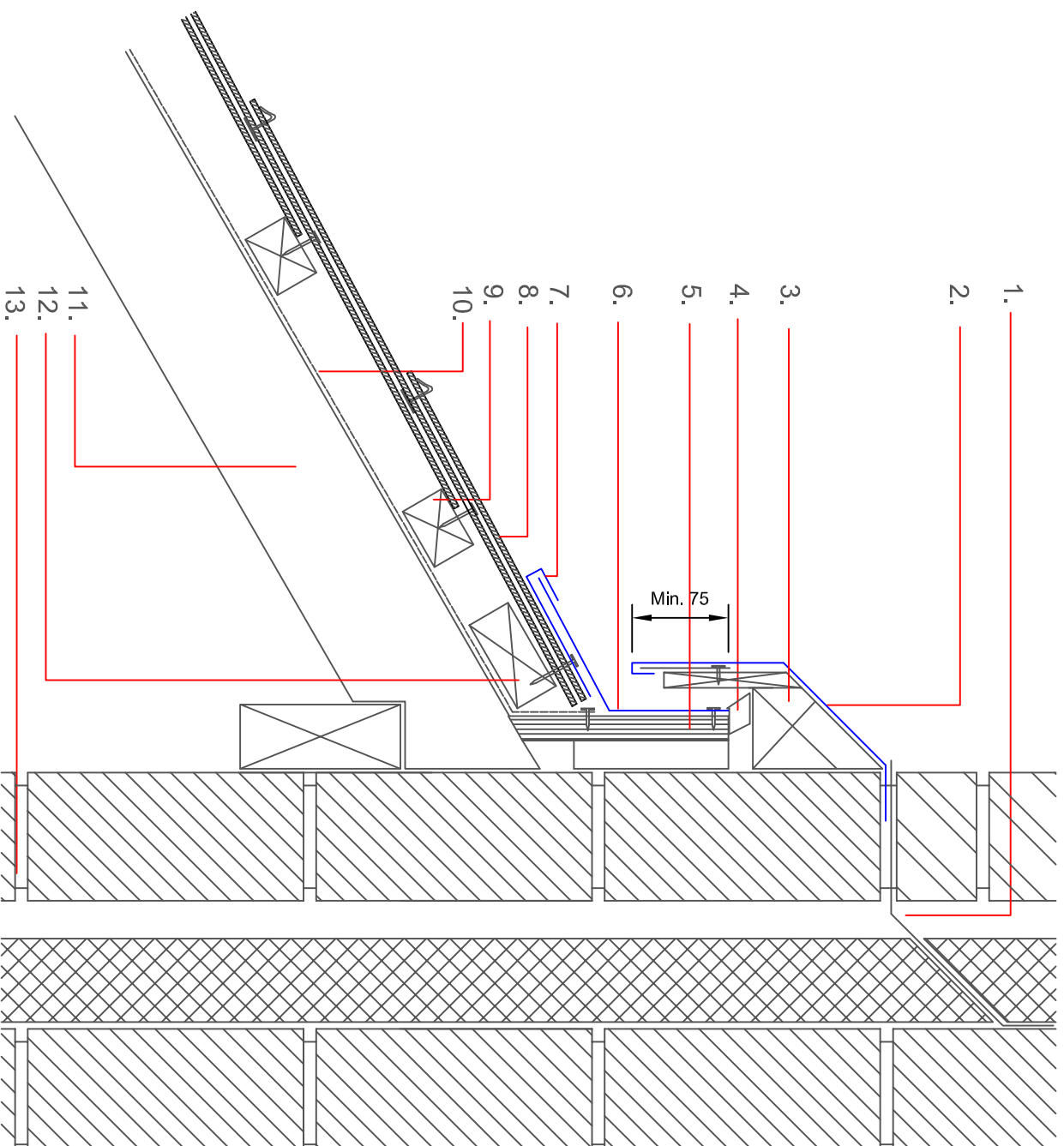

Drawing title  
**STANDARD TOP ABUTMENT  
 WITH CONTINUOUS VENTILATION**

Tegral Reference  
**TT-ABT-04-STD**

Scale  
**1:5**

Product

Copyright Tegral Building Products Ltd. © This information is supplied in good faith but no liability can be accepted for any loss or damage resulting from use.

Project title

Date:

Dwg.No.

**Tegral Building Products Limited**  
 Athy, Co. Kildare, R14 VN84

Email: [support@tegral.com](mailto:support@tegral.com)

Call: +353 (0)59 863 1316